

Student Preview

Last Modified on 03/06/2025 3:07 pm HKT

Common Usage of Student Preview

- Check Tests and Assignments which are available to students.
- Check release condition “Membership” setting (e.g. enroll the preview user account to a certain group to check if an item is visible/invisible to the group).
- *Note: Student Preview is not available for Panopto Video ([More information](https://support.panopto.com/s/article/Blackboard-Student-Preview) (<https://support.panopto.com/s/article/Blackboard-Student-Preview>))*

Steps

Ultra Course View

Please refer to Blackboard Help: [Student Preview](https://help.blackboard.com/Learn/Instructor/Ultra/Courses/Student_Preview) (https://help.blackboard.com/Learn/Instructor/Ultra/Courses/Student_Preview)

Original Course View

To enter Student Preview:

1. Click "Student Preview".

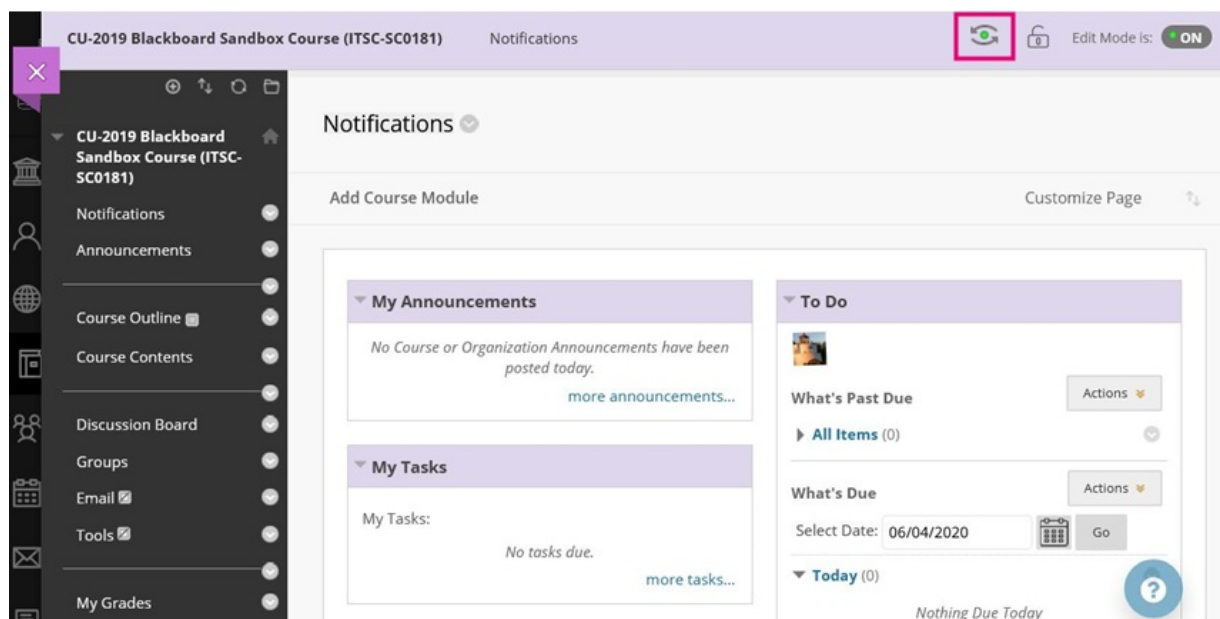

2. Student Preview mode is ON.

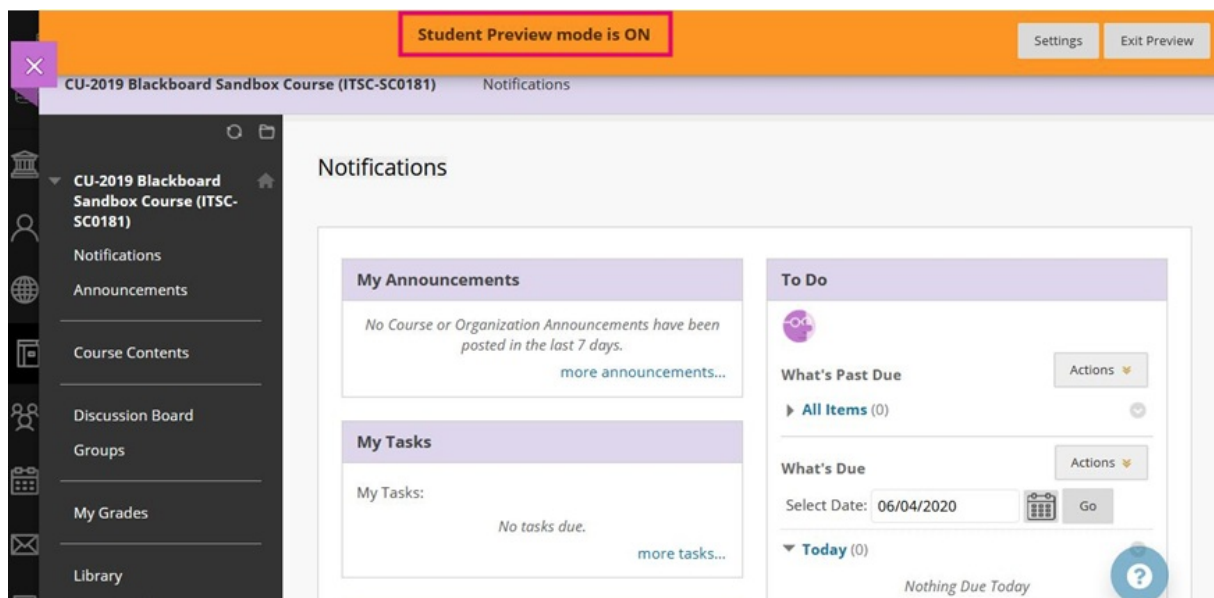

- When you enter student preview mode and are logged in to your course with the preview user account, your preview user appears in the course roster.
- The last name is your last name appended with _PreviewUser and the username is your username appended with _previewuser.

Users

Search: Username Not blank Go

USERNAME	FIRST NAME	LAST NAME	EMAIL	ROLE	OBSERVER	AVAILABLE
				Teaching Assistant / Support Staff		Yes
				Instructor		Yes
_previewuser		_PreviewUser		Student		Yes

- The preview user is visible to all students enrolled in the course.

To exit Student Preview:

1. Click on "Exit Preview".

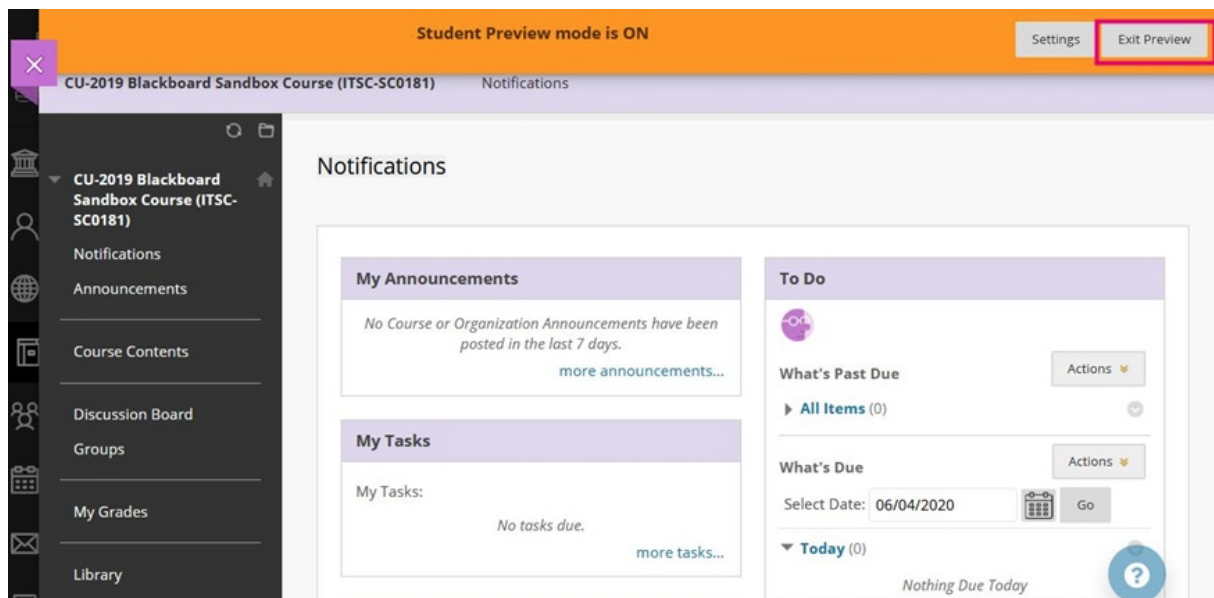

2. Keep the preview user's data for further checking OR delete your preview user account.

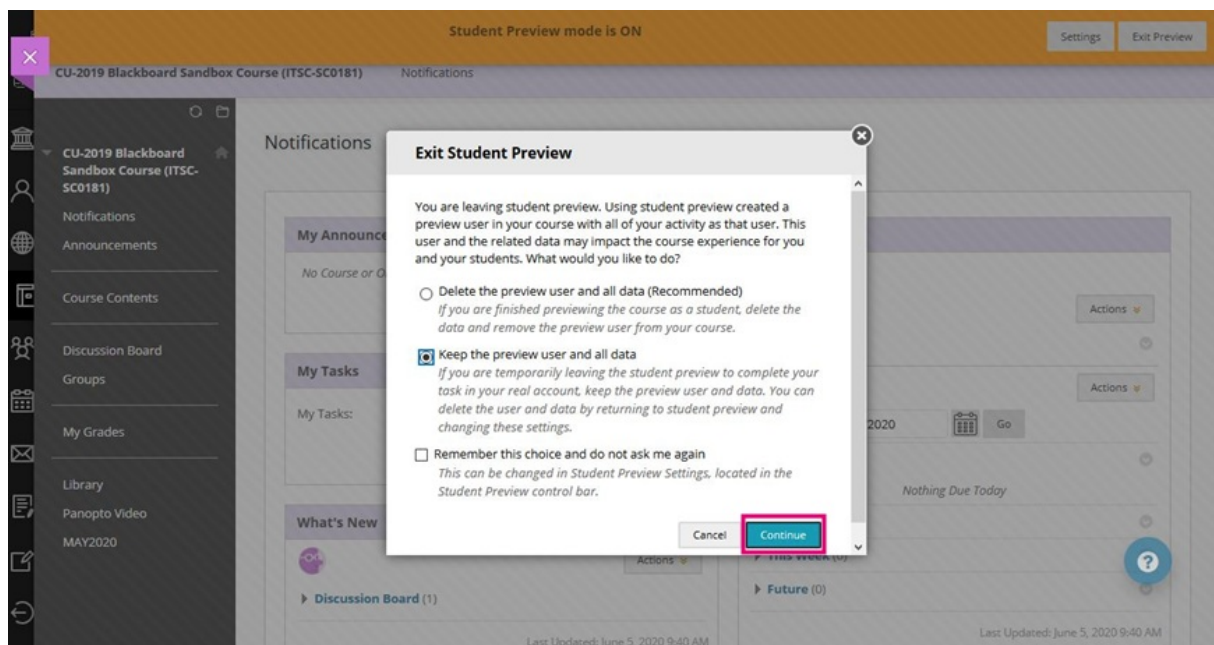

Contact us: elearning@cuhk.edu.hk / ITSC Service Desk (<https://servicedesk.itsc.cuhk.edu.hk>)